

PLEASE CHECK WWW.MOLEX.COM FOR LATEST PART INFORMATION

Part Number: 0190710225
Status: Active
Description: InsulKrimp™ Ring Tongue Terminal for 6 AWG Wire

Documents:
[Drawing \(PDF\)](#) [RoHS Certificate of Compliance \(PDF\)](#)
[Product Specification PS-19902-009 \(PDF\)](#)

General	
Product Family	Ring and Spade Terminals
Series	19071
Crimp Quality Equipment	Yes
Mil-Spec	N/A
Product Name	InsulKrimp™
Type	Ring
Physical	
Barrel Type	Closed
Color - Resin	Natural
Insulation	PVC
Material - Plating Mating	Tin
Packaging Type	Bag
Stud Size	1/4" (M6)
Wire Insulation Diameter	11.20mm (.440") max.
Wire Size AWG	6

Material Info	
Old Part Number	E-660-14X

Reference - Drawing Numbers	
Product Specification	PS-19902-009
Sales Drawing	SD-19071-015

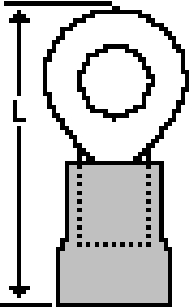

Series image - Reference only

EU RoHS
ELV and RoHS
Compliant
REACH SVHC
Not Reviewed
Halogen-Free
Status
Not Reviewed

China RoHS

Need more information on product environmental compliance?

Email productcompliance@molex.com
For a multiple part number RoHS Certificate of Compliance, [click here](#)

Please visit the [Contact Us](#) section for any non-product compliance questions.

Search Parts in this Series
19071Series

Application Tooling FAQ <i>Tooling specifications and manuals are found by selecting the products below. Crimp Height Specifications are then contained in the Application Tooling Specification document.</i> Global	
Description	Product #
Manual Putt Pump Hydraulic System, Die set required	0192860117
Die Set (large) for the HHLS Hydralic Crimper	0192890004
Hand Crimp Tool	0640013900
Putt Pump Dieless Head System	0192860065

10	9	8	7	6	5	4	3	2	1
MATERIAL NO.	ENG. NO.	STUD SIZE	$\phi S \pm .005$						
190710218	E-660-08X	08	.173						
190710221	E-660-10X	10	.198						
190710225	E-660-14X	1/4	.265						
190710229	E-660-56X	5/16	.328						

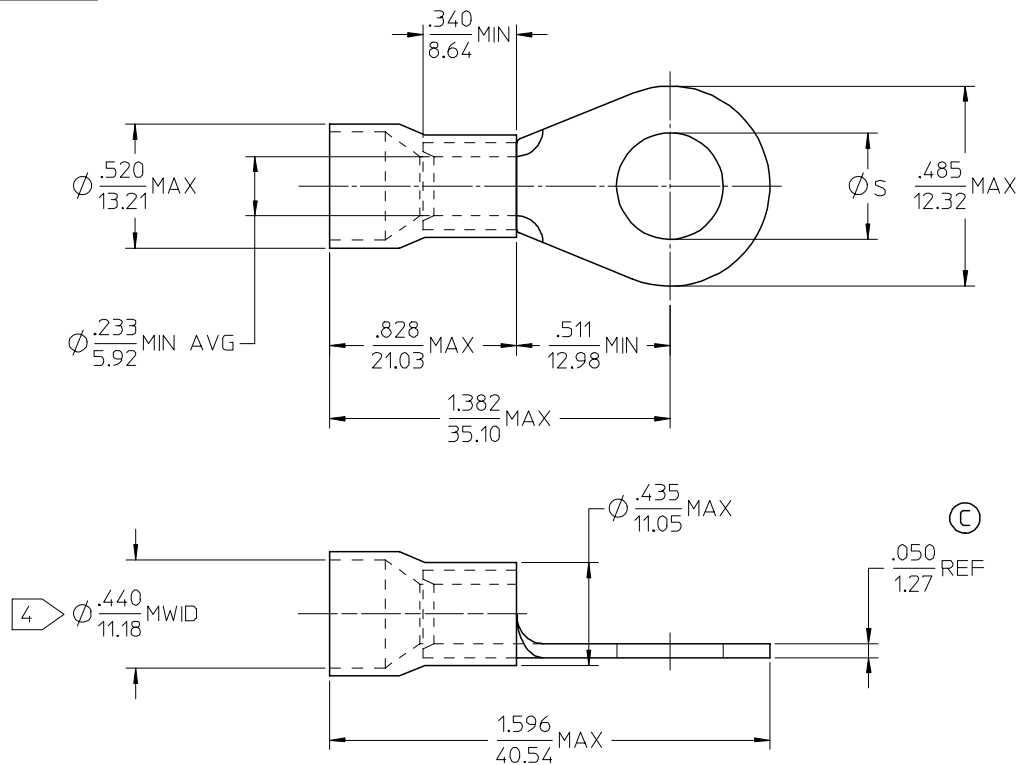

NOTE(S):

1. TERMINAL MATERIAL: COPPER ALLOY.
2. TERMINAL FINISH: ELECTRO TIN PLATE.
3. INSULATION MATERIAL: PVC, COLOR CODED BLUE.

4 MWID = MAXIMUM WIRE INSULATION DIAMETER.

5. ALL COMPONENTS ARE ROHS COMPLIANT.

REDWN & RDC MATL THKNS		QUALITY SYMBOLS ▽=0 ▽=0	DESCRIPTION	GENERAL TOLERANCES (UNLESS SPECIFIED)		DIMENSION STYLE IN/MM		SCALE 4:1	DESIGN UNITS INCH	THIRD ANGLE PROJECTION		
EC NO: ETC2007-0158	DRWNR: EHILE 2006/10/20			mm	INCH	DRAWN BY	DATE	TITLE RING TONGUE TERMINAL INSULKRIMP, 660 SERIES 6 AWG				
	CHKD: JMACNEIL 2006/10/20			4 PLACES	± ---	± ---	EHILE					
	APPR: JMACNEIL 2006/10/20			3 PLACES	± ---	± ---	CHECKED BY	DATE				
				2 PLACES	± ---	± ---	JMACNEIL	2006/10/10				
				1 PLACE	± ---	± ---	APPROVED BY	DATE				
				ANGULAR ± ---°		JMACNEIL	2006/10/10	MOLEX MOLEX INCORPORATED				
				DRAFT WHERE APPLICABLE MUST REMAIN WITHIN DIMENSIONS		MATERIAL NO.		DOCUMENT NO.		SHEET NO.		
						SEE CHART		SD-19071-015		1 OF 1		
						THIS DRAWING CONTAINS INFORMATION THAT IS PROPRIETARY TO MOLEX INCORPORATED AND SHOULD NOT BE USED WITHOUT WRITTEN PERMISSION						
				SIZE B								